



Manufactured by:
Eclectic Products, Inc.
Pineville, LA 71360

Made in the USA

800.767.4667 - Technical Services

www.eclecticproducts.com

TECHNICAL DATA SHEET

FAMOWOOD® Instant Wood Repair **Non-sag Formula**

PRODUCT DESCRIPTION

FAMOWOOD® Instant Wood Repair is a two-component polyurethane (2:1 ratio by volume) resin system that is less than 1% VOC and contains no solvents. It's designed for wood restoration and repair of defects, such as holes, cracks and gouges, for virtually any job large or small. **FAMOWOOD Instant Wood Repair** can be applied on to flat, sloped and/or vertical surfaces without running, dripping or shrinking, and can be troweled for precise coverage to mirror the original surface. The product can be applied using hand-held cartridge dispensing applicators (top loading caulk gun for 6.1 fl. oz./180 mL) for small applications, or using EPI/WVCO's metering equipment for larger industrial applications. The two components combine through a static mix tube for effective mixing with minimal waste.

INDUSTRIES & APPLICATIONS

LOG HOME - Repair and Restoration

DOOR & MILLWORK COMPANIES - Trim Work,
Base & Crown Moldings

MARINE - Boat Docks and Pilings

CABINET MANUFACTURERS - Cabinet Restoration

CONSTRUCTION / REMODELING - Fills Voids for
Window Replacement, Deck Repairs, Architectural
Timber Repairs and Dry Rot Wood Repairs

PRODUCT CHARACTERISTICS & BENEFITS

Available sizes	Two sizes: 6.1 fl. oz. / 180 mL and 13.5 fl. oz. / 400 mL. Metering equipment available.
Substrates	All wood species
Non-Structural Use	Material will not impact structural rating or certification of any wood repair.
Adhesion to Wood	Passed as specified by the American Plywood Association (APA) for adhesion on wood (boil test).
Non-Sag	Yes. Mixed resin can be applied on vertical and sloped surfaces without running or dripping.
Non-Shrinking	Yes
Application Temperature	Optimal temperature range is 65° to 85°F (18° to 29°C). Product may be applied at temperatures outside of this range (35° to 100°F / 2° to 38°C); however, working time and tack free time may be shorter or longer.
Working/Set time	When a clean finish is desired and sanding is not possible, it is recommended to protect adjacent surfaces with painter's tape. Material can be troweled for up to 2 minutes at optimal application temperatures between 65° to 85°F (18° to 29°C). Remove tape as soon as possible after applying FAMOWOOD Instant Wood Repair.
Full Cure Time	24 hours after application. <i>Note:</i> Polyurethanes cure faster at warmer temperatures and slower at cooler temperatures. Large repairs cure faster than small repairs.
Curing Process	Curing process produces heat. Polyurethane reaction is exothermic. Dispensed material can become hot during application and curing, especially when applied in large volumes.
Stainable	Accepts stains
Finishing	Yes, after 1 hour. Sandable, Machinable, Planeable, Paintable.

TECHNICAL DATA SHEET

PROPERTIES OF UNCURED MATERIAL

Vehicle Type	Resin system consists of two liquid components.
Color	Light Brown. Other colors available for large volumes.
Density	Part A - Resin Side = 8.5 - 8.8 lb./ga. (1.02-1.03 gm/ml) Part B - Hardener (Isocyanate) Side = 10.3 lb./ga. (1.23 gm/ml)
Mix Ratio	2:1 by volume (2 volumes Part A to 1 volume Part B)
Solids	100% solids; No solvents.
VOC (Resin)	Less than 1%
VOC (Iso)	0%; Iso has no VOC.
Storage	Store in dry area between 50°F (10°C) and 80°F (27°C). Keep away from moisture.
Freeze/thaw stability	Stable
Shelf life	2 years unopened (from date of manufacturing)

PROPERTIES OF CURED MATERIAL

UV resistance	Polyurethane is not sensitive to UV degradation; however, certain colors may change slightly.
Shore Hardness	60 Shore D (after 24 hour cure at room temperature)
Heat resistance	Cured resin has very good heat resistance (+250°F / +121°C)

SAFETY PRECAUTIONS AND SUPPLIES NEEDED

- Use safety eyeglasses, latex/nitrile gloves, and a drop cloth when using the FAMOWOOD Instant Wood Repair system.
- **CAUTION! Curing process produces heat. Polyurethane reaction is exothermic. Dispensed material can become hot during application and curing, especially when applied in large volumes. Keep away from children.**
- When sanding is not possible, it is recommended to protect adjacent surfaces with painter's tape. Remove tape as soon as possible after apply FAMOWOOD Instant Wood Repair.
- Read Material Safety Data Sheets carefully. To request an MSDS, please send an email to msds@eclecticproducts.com or call 800.333.9826 (Willamette Valley Company Safety & Compliance).

PRODUCT AND APPLICATION NOTES

- Optimal temperature range is 65° to 85°F (18° to 29°C). Product may be applied at temperatures outside of this range (35° to 100°F / 2° to 38°C), however, working time and tack free time may be shorter or longer.
- It is important to shake cartridge for one minute prior to use to ensure thorough mixing of pigment.
- After filling mix tube, be sure to properly discard the first inch of dispensed material into a waste container to ensure the polyurethane components are mixed in the same ratio. This will result in consistency in the final product properties. The fully mixed color is light brown, and once light brown is reached, immediately dispense into the area to be filled or repaired.
- Unused material can be save for later use by removing the mix tube and replacing the nose plug cap and keeper ring, or by keeping the used mix tube intact.
- The mixed resin can be applied to flat, sloped and/or vertical surfaces without running, dripping or shrinking. There is no need to use any dams to contain the liquid resin.
- If working with a vertical application, apply FAMOWOOD Instant Wood Repair from bottom to top.
- The dispensed resin allows the user to trowel and shape it as the wood surfaces require.
- When flow of resin coming out of the mix tube slows down, it is time to replace mix tube.
- Material can be troweled for up to 2 minutes at optimal application temperatures between 65° to 85°F (18° to 29°C). Troweling after the 2 minute set time may result in some of the material pulling out of repair. Remove tape as soon as possible after applying FAMOWOOD Instant Wood Repair.

(continued next page)

TECHNICAL DATA SHEET

PRODUCT AND APPLICATION NOTES (continued)

- Always keep moisture away from uncured polyurethane components. A dry surface will minimize foaming.
- The Part B Side (Hardener) contains isocyanate. It has extremely low vapor pressure, and therefore is very unlikely to become airborne.
- Acetone can be used to assist with cleanup of tools and working area.

MANUAL OPERATING INSTRUCTIONS



illustration #1



illustration #2



illustration #3



illustration #4



illustration #5

1. Please read all instructions, safety precautions, and application notes before using FAMOWOOD Instant Wood Repair.
2. Wood surface should be clean, dry, and free from oil and grease before the area is filled. A dry surface will minimize foaming of material. Paint and/or rotten wood must be removed. Any rotten wood remaining will continue to rot once repair has cured. When working on painted wood, make sure paint is well adhered to wood. Loose paint chips will affect overall adhesion to wood.
3. It is important to shake cartridge for one minute prior to use to ensure thorough mixing of pigment. **(#1)**
4. Hold the cartridge upright to prevent liquid material from escaping during assembly. Unscrew the retaining nut on the top of the cartridge to remove the nose plug. **(#2)**
NOTE: for 400 mL cartridges, first remove keeper ring from nose plug, then unscrew retaining nut to remove nose plug.
5. Holding the cartridge upright, place the mix tube on to the top end of cartridge set and replace the retaining nut. To prevent leakage, make sure the mix tube assembly is fully secured with the retaining nut tight. **(#3)**
6. Place cartridge into dispensing gun. Make sure the retaining nut is outside the frame assembly of the dispensing gun. Push plunger rod forward to be engaged with cartridge. **(#4)**
7. Hold dispensing gun upright and depress the trigger to slowly fill mix tube. **(#5)**
8. Fill the entire mixing tube with FAMOWOOD Instant Wood Repair while pointing the mix tube upward.
9. After filling mix tube, be sure to properly discard the first inch of dispensed material into a waste container to ensure the polyurethane components are mixed in the same ratio. This will result in consistency in the final product properties. The fully mixed color is light brown, and once light brown is reached, immediately dispense into the area to be filled or repaired. When flow of resin coming out of the mix tube slows down, it is time to replace mix tube.
10. When a clean finish is desired and sanding is not possible, it is recommended to protect adjacent surfaces with painter's tape. Material can be troweled for up to 2 minutes at optimal application temperatures between 65°-85°F (18°-29°C). Troweling after the 2 minute set time may result in some of the material pulling out of repair. Remove tape as soon as possible after applying FAMOWOOD Instant Wood Repair.
NOTE: Polyurethanes cure faster at warmer temperatures and slower at cooler temperatures. A large repair will cure faster than a small repair.

(continued next page)

TECHNICAL DATA SHEET

MANUAL OPERATING INSTRUCTIONS (continued)

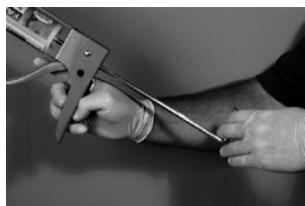

illustration #6

11. To help prevent the material from dispensing during the troweling step, set dispensing gun aside, depress release lever and pull plunger rod back to start position.
12. Application can be machined, sanded, planed, painted and will accept a stain after 1 hour.
13. To remove empty cartridge, depress release lever, pull plunger rod back to start position and pull cartridge out. (#6)

PRODUCT SUPPORT

WILLAMETTE VALLEY COMPANY

Robert Pitts, Business Manager
12robertp@wilvaco.com

ECLECTIC PRODUCTS, INC.

Allen Miller, Industrial Sales Manager
35allenm@wilvaco.com

MSDS REQUEST

800.333.9826

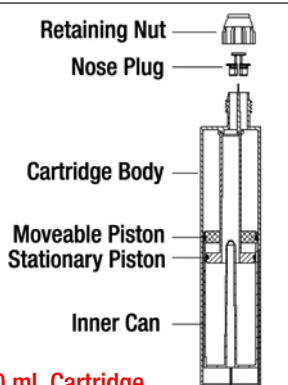

6.1 Fl. Oz./180 mL Cartridge

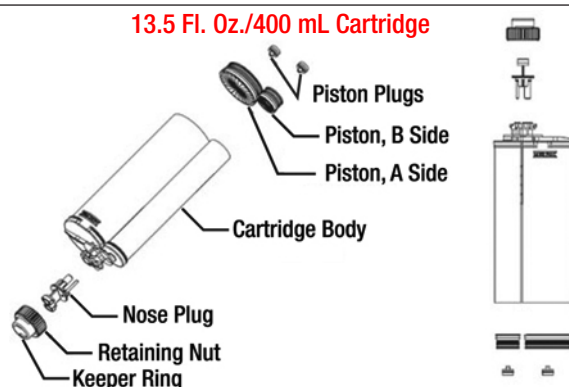

HAZARDS

This product is supplied to the customer in a ready to use form. It is best applied using metering equipment for large projects or industrial applications. Care should be taken to avoid any contamination with foreign matter including moisture. In case the material is spilled or released, consult MSDS of both components for proper cleaning and handling. To request an MSDS, please send an e-mail to msds@eclecticproducts.com or call 800.333.9826.

FOR CHEMICAL EMERGENCY CALL INFOTRAC — 1.800.535.5053
24 hours a day, 7 days a week

LIMITED WARRANTY

The product is warranted against any defect in materials or workmanship, providing a claim is made in writing within 180 days after the sale of the product. THE EXCLUSIVE REMEDY FOR ANY DEFECTS IN MATERIALS OR WORKMANSHIP SHALL BE THE OBLIGATIONS OF THE SELLER TO REPAIR OR REPLACE ANY PRODUCT WHICH SHALL BE DETERMINED, TO THE SATISFACTION OF SELLER UPON SELLER'S EXAMINATION, TO HAVE BEEN THUS DEFECTIVE. For warranty service, the buyer should contact the store where the product was purchased, or write to: Willamette Valley Company or Eclectic Products, Inc., PO Box 4450, Pineville LA 71361 or call 800.444.9826 (WVCO); 800.767.4667 (EPI).

SELLER MAKES NO EXPRESS OR IMPLIED WARRANTIES OF ANY KIND, INCLUDING THE IMPLIED WARRANTIES OF MERCHANTABILITY AND OF FITNESS FOR ANY PARTICULAR PURPOSE OTHER THAN STATED HEREIN. THE REMEDIES PROVIDED HEREIN ARE THE EXCLUSIVE REMEDIES TO BUYER, AND SELLER SHALL NOT BE LIABLE FOR ANY LOSS, INJURY OR DAMAGES TO PERSONS OR PROPERTY RESULTING FROM FAILURE OF THE PRODUCT OR ANY DEFECT IN THE PRODUCT SOLD HEREUNDER, OR ANY DELAY IN PERFORMANCE BY SELLER, NOR WILL SELLER BE LIABLE FOR DIRECT, INCIDENTAL, CONSEQUENTIAL, SPECIAL OR ECONOMIC DAMAGES OF ANY KIND, OR FOR CONTRIBUTION OR INDEMNITY CLAIMS, HOWEVER CAUSED, WHETHER FOR BREACH OF WARRANTY, CONTRACT, TORT (INCLUDING NEGLIGENCE), STRICT LIABILITY, OR OTHERWISE.